

# WISDOMSHOUSE

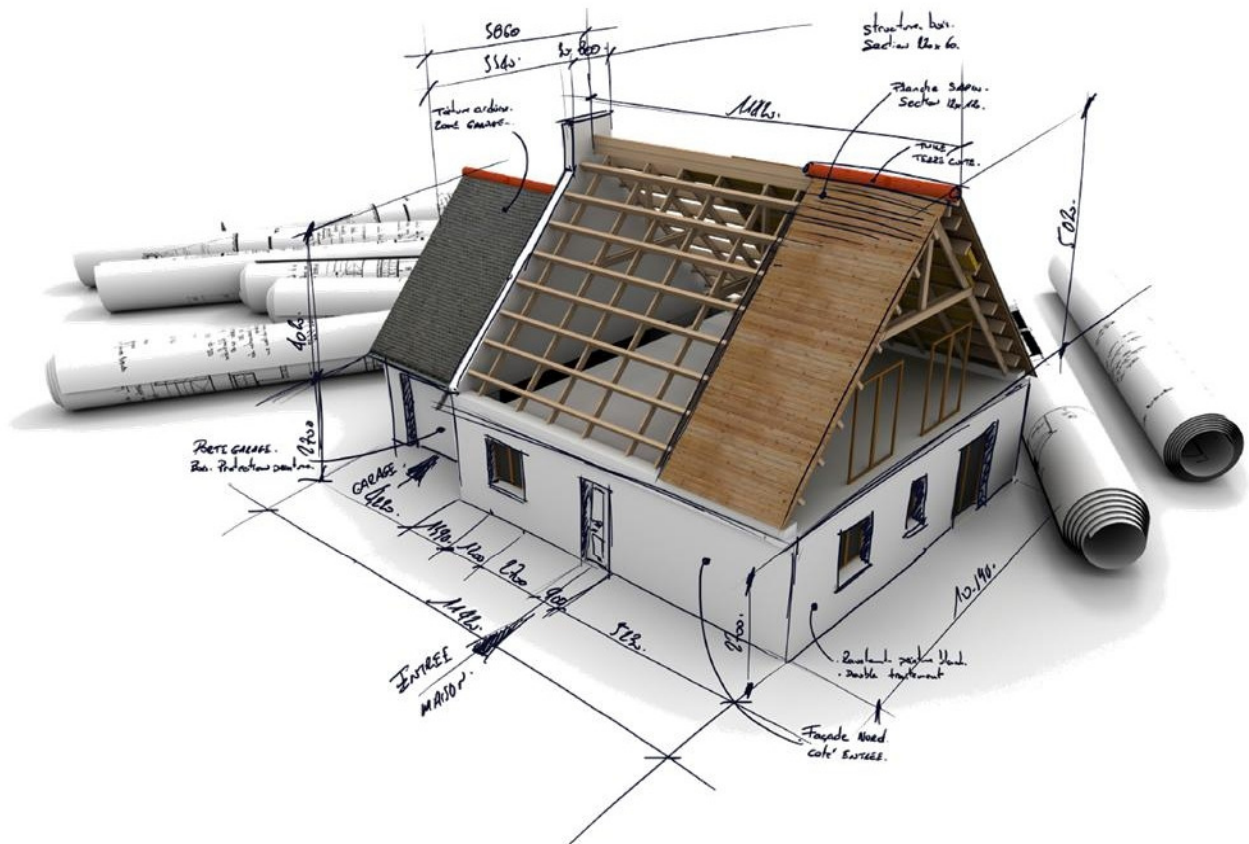

## Start Me Up!

CD Special Edition of Weeks 1-7

Introductory Course to Wisdom's House  
Training Manual & Syllabus

©Wisdom's House Publications 2010 - CD Special Edition

# Start Me Up!

A Fourteen Week Introduction Course  
To

## Wisdom's House

A House of Prayer and an Equipping Center

This manual contains the first  
Seven Weeks  
General Introduction

## CD Special Edition

## Training Manual & Syllabus

Wisdom's House Publications

[www.wisdomhouse.org](http://www.wisdomhouse.org)

brett@wisdomhouse.org

The Spirit of Wisdom will cause you to . . .

**Elevate your perspective.**

(Seeing your life, family, communities, & city with Heaven's Eyes.)

and therefore

**Increase your efficiency.**

(Accomplishing the things you are on the hook for in heaven.)

# Our Mode of Operation:

We are currently releasing the  
Message of Wisdom through  
City Seminars and the Start Me Up!  
Intro-Equipping Courses.

While some day there may be a building  
called Wisdom's House, where saints come to  
pray and be equipped, we have purposed to  
release the message into The Church of a city  
before there is a location called . . .

**Wisdom's House**  
A House of Prayer and Equipping Center

# Wisdom's House

A House of Prayer and Equipping Center

[www.wisdomshouse.org](http://www.wisdomshouse.org)

## Vision

Cities that Prosper as Beacons of Light and Places of Refuge.

## Mission

To Equip The People of God in Night and Day Worship & Prayer  
While Training Them to Build their Life, Family, Community, and City  
by The Spirit of Wisdom

## Building Strategies

### **Equipping Individuals:**

Increasing the efficiency and eternal productivity of those who serve Jesus.  
Building individuals, not institutions; people, not personalities.

### **Mentoring Families:**

Building nuclear families that play together, pray together, and stay together.  
Training the Body of Christ to release the Kingdom of Heaven from Parents to Children.

### **Serving Communities:**

Cultivating a custom of service that creates community and changes culture in the  
"Seven Societal Mountains."  
(Family, Religion, Government, Business, Education, Arts & Entertainment, Media)  
Modeling an efficient business plan for the Religion Mountain.

### **Restoring Cities:**

Rebuilding the ancient walls and ancient foundations of a city by equipping God's people to  
strategically care for the poor.  
Restoring 'Faithful City' status to cities by pleading the case of the single-mother and defending  
the cause of the fatherless.

# An Invitation

## To All Who Would Hear Wisdom's Cry:

Wisdom's House is very simply the Family of God. The Message of Wisdom was unveiled at the Cross, but originated before the foundations of the earth when the LORD chose The Spirit of Wisdom as His general contractor to lay the foundations of the earth and to build His house. Wisdom builds by love. This includes: going after the next generation, very intentionally equipping the poor, releasing the LORD's Kingdom through sacrifice and service in every sphere of life, crying out with revelatory intercession, and living a life that is consistent with Heaven's Kingdom. All as a result of, and compelled by, Jesus' perfect love.

We welcome you to embark on your own journey of intimacy with Jesus and be a living stone that He places right where He wants you to be as He builds His House. When we see The Church as Christ's Body, God's Family, and the vessel through which He releases His Kingdom in the earth, we no longer look at a building as the church, it is only the place where The Church meets. Soon we will see The Church in a city as one house with many rooms; each congregation being a room in a bigger House. We are all on our individual journey of intimacy. We want to meet you where you are at ease, and gently make you uneasy. You might say that we are here to comfort the afflicted and afflict the comfortable. (In love, of course.)

Please come and join Jesus as He builds His Family. When we truly discover how much Jesus loves us and how He gave His life for us, we get the deep desire to lose our lives for Him and others. This is Wisdom. In this place, sacrificing for Him becomes less unreasonable maybe even desirable, and His Body becomes a very powerful, efficient, productive, and effective force in the earth. This is how He intended for His Church to build His Kingdom, His Family, His House.

Grace and peace to you and your family,

Brett & Michelle Costigan

# Start Me Up!

## General Introduction to Wisdom's House

Wisdom's House Publications

[www.wisdomshouse.org](http://www.wisdomshouse.org)

### Table of Contents

|  |         |
|--|---------|
| Cover Page .....   | Page 2  |
| An Invitation .....  | Page 6  |
| Table of Contents .....  | Page 7  |
| Introduction Letter .....  | Page 9  |
| First Seven Weeks Overview .....   | Page 12 |
| <br>   |         |
| Week 1 - Heaven's dreams, and Two kinds of wisdom .....                    | Page 14 |
| Week 2 - Wisdom at creation, and Wisdom's House - The Family of God .....  | Page 17 |
| Week 3 - Jesus Life - Built by Wisdom and Wisdom at the Cross .....        | Page 20 |
| Week 4 - Wisdom's builds Lives and Wisdom's call to Parents and Kids ..... | Page 23 |
| Week 5 - Wisdom builds Families - Yours and the LORD's! ... ..             | Page 26 |
| Week 6 - Wisdom builds Communities. What is a FRoGBEAM? .....              | Page 29 |
| Week 7 - Wisdom builds The Church - by City; Key: The Poor .....           | Page 32 |
| <br>   |         |
| The Focus of Four Expanded .....   | Page 34 |
| The "New" Cultures of Wisdom's House .....                                 | Page 35 |
| Some "New" Wisdom's House Language .....                                   | Page 36 |

# Wisdom is First.

Proverbs 4:7

Dear Friend,

Grace and peace to you from the One who is, who was, and who is to come, and from the Seven Spirits before His throne, and from Jesus Christ, who is the Faithful Witness, and the Firstborn among the dead, the Ruler of the Kings of the Earth. (Revelation 1: 4-5)

I want to start out with an invitation that is meant also to be considered a fair warning. If you've ever had someone pull the old 'bait-and-switch' on you, you know how it feels to be led into something with bells and whistles only to return with something much less than you expected. I've got to be honest with you, this course and the resulting revelation won't be easy. I know the end of the matter and therefore I feel comfortable starting with a compassionate call to repentance. Not for any specific sin you've committed, but it has been my observation that when The Spirit of Wisdom releases revelation to our hearts and minds, we feel compelled to change our ways, to repent.

Solomon wrote of Wisdom that she gives kings and princes their ability to rule, and fills treasuries beyond our comprehension, but of this same Wisdom he also wrote in Ecclesiastes 1:18 "With Wisdom comes much sorrow..." The eye-opener that the Spirit of Wisdom provides will cause you to weep over that which Heaven weeps over and also bring you to the reality, "Does not Wisdom Cry Out...?" (Proverbs 8:1) this cry originates in the depths of the greatest treasure - intimacy with Jesus - that only the Spirit of Wisdom can provide. You will also begin the wonderful growth cycle:

### INTIMACY ~ REVELATION ~ INTERCESSION.

You see, a violent pursuit of *intimacy* with Jesus will lead you to Wisdom, and the *revelation* she provides, from there you will not be able to keep yourself from *interceding* between Heaven and earth. Keep in mind, all prayer is intercession, but not all intercession is prayer. A good portion of our intercession is about what we DO. Matthew reports Jesus saying, "Wisdom is known (proven or vindicated) by her "works" or "actions." (Matthew 11:19) This training course will help your productivity increase by being focused on the specific works that are on your "to do list" in Heaven. Seeing with Wisdom's revelation will open the eyes of your heart concerning God's love for you and also the value of the time you have on the earth. You will have an increased desire to redeem the times of your life as Isaiah said, "He will be a sure foundation for your times, a rich storehouse of salvation, wisdom, and knowledge; the fear of the Lord is the key to this treasure." (Isaiah 33:6.) With this foundation, the cross-like sufferings of this life will somehow become small in comparison to His resurrection power and glory that is released in and through you.

Without a vision, or revelation, the people perish, cast off restraint or 'remove their boundaries' (Proverbs 29:18.) We are all prone to do this by living for short term success and pleasure . . . but WITH revelation and vision, the people of God see what Heaven sees and work to bring the LORD's Kingdom to earth. We want you to have a vision for:

### **"Cities that prosper as beacons of light and places of refuge."**

It is the Lord's intent that through The Church the manifold Wisdom of God be revealed to the principalities and powers of the unseen realm (Ephesians 3:10.) This training course will be an introduction to the idea that if we join with Heaven's manifold Wisdom, the LORD's general contractor, each one of us will learn how to build our Life, Family, Community, and City according to Heaven's blueprints, and the rulers and authorities in the heavenly realms will get the point. This course will introduce you to many new perspectives. To a world-view that 1) makes King Jesus both our servant example and our ruling role model, 2) measures The Church in increments of cities, and 3) causes us to quickly recognize Satan's wisdom-of-the-age . . . and that is just for starters. We intend to meet you where you are comfortable, and a gentle nudge into the uncomfortable. We want you to see Cities that prosper as beacons of light and places of refuge. This vision is attainable if we help the people of God cultivate efficient, effective, and productive Lives, Families, Communities, and Cities. ***This is going to take some work and will not be easy, so consider this your fair warning.*** If you join Wisdom and begin to build according to the LORD's plan, you will never be the same! The great benefit is that on the day you see Jesus you will have more gold and less stubble because you made every effort to do only what He said to do and said only what He said to say by GETTING Wisdom (Proverbs 4:7.)

It is with confidence that I invite you to a journey into better vision; the *Journey of Intimacy*. As you assimilate this world-view through these **teachings and House of Prayer (HOP), the new language culture, and the simple action culture**, you will begin to feel like you are becoming an expert at common sense. You will watch as your efficiency and productivity in the Kingdom of Heaven begins to increase, and when you are face to face with Jesus there will be more gold, silver, and precious stones and less wood, hay, and stubble as His Love-Fire consume you. You will see your city, your communities, your family, and your life from a different perspective, Wisdom's perspective. These will all come as a result of one beautiful yet important thing: simple and pure devotion to Jesus. You will be hidden with Christ, in God, and this will cause you to walk as Jesus walked . . . one with His Father. You will sense the value of time and begin to increase your intimate walk at first week by week, then day by day, and ultimately moment by moment in communion with Jesus.

The Message of The Spirit of Wisdom is sprinkled throughout the written Word from Genesis to Revelation. It is, by its very nature, "apocalyptic." This Greek word, found in Ephesians 1:17, is also the name of the last book of the Bible, REVELATION. It is a compound word: apo - similar to English prefix "un" as in 'un'happy AND kalupto - which means to cover or hide. Together they mean: unhide, disclose, uncover or reveal. So, critical to our understanding of the nature of the Spirit of Wisdom is that it uncovers, unveils, and unhides that which is in the realm of eternity, the realm of the unseen. When Paul, on behalf of the people of Ephesus (Ephesians 1:17), continually asked that "The God of our Lord Jesus, the Glorious Father, pour out the Spirit of Wisdom and Revelation SO THAT they might *intimately* know Him." - he knew something about The Spirit of Wisdom that most did not know. Wisdom would REVEAL to them Jesus so that they could intimately know and be one with Him. Paul had been to the third Heaven and probably seen much of what John saw - the throne room, the seven lamps (seven spirits), the four Living Creatures, the seven Lampstands (seven churches), and maybe Paul even saw the seven eyes and seven horns on Jesus - which are the Seven Spirits of God (Revelation 5:6.) You see the Spirit of Wisdom (one of the Holy Spirit in seven - Isaiah 11:2) is primary in unveiling THIS most important revelation which Paul said was overwhelmingly for one purpose: Intimate Oneness with Jesus. It is by Wisdom that the Great I AM, the LORD, founded the earth. It is also by Wisdom that a house is built. A house is a family, Wisdom's House is the LORD's Family, and it is built out of intimacy with Jesus.

Your vision of life might change if you GET Wisdom, so I will keep on asking for the Father to pour out His Spirit of Wisdom and revelation so that you might know and have intimacy with His Son. It is my hope the impact of The Message of Wisdom and the Seven Spirits will help you begin to see better. If you are born again, you already have spiritual vision, for the things of the spirit are revealed to us by Jesus Spirit (1 Corinthians 2:12.) Over the years, in my journey of intimacy with Jesus, the idea/revelation of the Holy Spirit in Seven or the Seven Spirits of God began to move from abstract, figurative, and bizarre to a little intriguing and somewhat acceptable, and then from acceptable to greatly desirable. They are both Heaven's eyes and lamps for they cause us to both receive and release light, illumination, revelation. They are Heaven's horns, for they bring great strength to the children of God (Revelation 5:6.) The Eyes of Heaven help us see in completeness. I call it "septnocular" vision, just for fun. They rested on Jesus (Isaiah 11:2), and as you find them from Genesis to Revelation, they will cause the Living Word and the written Word to come to life. You already know them, but I invite you to begin to know each one by name. They are the Spirit of the LORD, Wisdom, Understanding, Counsel, Power, Knowledge, and the Fear of the LORD.

Keep in mind as you proceed, you will be seeing through your current glasses. Each one will be on their own schedule in the Lord; their own personal journey of intimacy with Jesus. This is the beginning and end of the message of Wisdom: "**Your personal intimate-oneness with Jesus and His Father.**" If you can "hold on loosely" you might find that you make progress sooner. Never set aside current revelation, only add to it. Let The Teacher (Jesus & His Spirit in You) teach you. I encourage you to above all GET Wisdom, for Wisdom is in the beginning, primary, first. Those who find her find life and receive favor from the LORD. Whoever fails to find her harms himself; all those who hate her, love death (Proverbs 8:35 & 36.)  
Enjoy the journey!

Grace and peace,

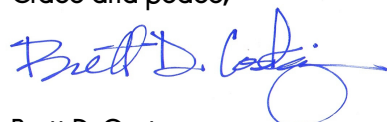

Brett D. Costigan

The LORD brought me (Wisdom) forth as the first  
of his works, before his deeds of old;  
I was appointed from eternity, from the  
beginning, before the world began.

Proverbs 8:22-23

# Start Me Up!

## General Introduction to Wisdom's House

Wisdom's House Publications

[www.wisdomhouse.org](http://www.wisdomhouse.org)

### The First Seven Weeks Overview

The course will start with seven weeks of a general (and believe it or not – brief) introduction to Wisdom's House. In these seven weeks you will learn a Biblical world-view concerning the Spirit of Wisdom. We will start in week 1 with two personal experiences the Lord gave me through a couple **powerful revelatory dreams** that, together, significantly helped define the message of Wisdom and the Seven Spirits. We will then set the stage with what are the two paths of life, the **two kinds of wisdom** found in the Garden of Eden and through all of human history. Then we briefly skim what are both generally our **current and historical understanding of wisdom** and move to what Moses, David, Solomon, the Prophets, Paul, John, and most importantly, what Jesus understood about the Spirit of Wisdom, as well as look at what many theologians today know "Wisdom" to be. We will learn in week 2 how **Wisdom was Yahweh's critical agent to lay the foundation for all of creation** and how the LORD uses **Wisdom to build both His House/His Family and also any House/personal life, nuclear family, sphere of community, and city**. Week 3 and 4 could be the most important for you . . . we will observe the big moment where **Wisdom was revealed at the Cross**, and connect the secret power of death with how Jesus wants **our lives to be Wisdom's first house**. We will help this by understanding heaven's **growth cycle of: INTIMACY~REVELATION~INTERCESSION**. In week 4 we see how to build our lives by following the example of **Jesus' life that was built by Wisdom**. Specifically, we will learn how it is the Spirit of Wisdom that prepares the Lord's Table for you to commune with the Father, have intimacy with Jesus, and fulfill all that is in His heart (Heaven's "to do list") for you to accomplish while you are on the earth. We will also see how Wisdom is for us "early" in life, therefore parents are accountable for getting Wisdom to their children. In week 5 we will build on **Wisdom's unique call to parents and also to kids** while looking a little more in depth at how Wisdom builds Families, both yours and the LORD's, by learning **how Wisdom builds a nuclear family and God's spiritual family, His Church**. The Family is where Wisdom begins to build cities that prosper because the Family is the first of the Seven Societal Mountains, so in week 6 we will learn how **Wisdom builds in ALL spheres of life**. We will begin to observe the Seven Pillars of Wisdom's house (Proverbs 9:1) and see how they MIGHT be these seven mountains: **Family, Religion, Government, Business, Education, Arts & Entertainment, and Media . . . FRoGBEAM**. We will look briefly at the origin of the Seven Mountain/Seven Societal Molders and how The Church is meant to release the Spirit of Wisdom and the Spirit of Adoption in the Seven Societal Mountains, and how the Religion Mountain should release this Kingdom world-view so that ALL God's people can build His Kingdom in every sphere of life. The last week of the first seven weeks will focus on how **Wisdom builds a city by "calling out" at strategic locations, and inviting the poor to her table**; this last class will be the introduction to what we will focus on the last seven weeks with the desired result being that you choose to be a part of a **City Building Team** – "Carecoaching" a single mom and her children, and hosting one hour a week in the House of Prayer.

Does not Wisdom cry out? Does not  
Understanding raise her voice?

Proverbs 8:1

# Start Me Up!

## General Introduction to Wisdom's House

Wisdom's House Publications

[www.wisdomshouse.org](http://www.wisdomshouse.org)

**Week 1:** During these two hours we will learn about two dreams that changed my life, and about two (or three . . .) Biblical kinds of Wisdom. We will also learn about how men of God from Moses to modern day theologians see the Spirit of Wisdom.

Most of us understand cognitive/experiential wisdom that, like wine, gets better with age and is passed from old to young. We will develop our understanding of the Spirit of Wisdom (Jesus as Wisdom or the Holy Spirit as Wisdom, primary among the Seven Spirits of God), and Satan's wisdom-of-the-age.

**Two dreams that changed my life.**

"Does Not Wisdom Cry Out!?" – 2000 Dream

"If You Cry Out, These Souls Will Live!" – 2006 Dream, like the next night.

SO: Wisdom's House is a House of Prayer – joining with Jesus in Intercession for the earth.

"My House will be a House of Prayer for All Nations."

**Two Kinds of Wisdom (or three . . . ?)**

**We are MOST familiar with: Cognitive/Experiential wisdom . . . (the 'third' kind.)**

The Almond Tree has blossomed.

Knowledge and understanding applied = wisdom.

The fruit of The Spirit of Wisdom.

**Satan's wisdom. (wisdom-of-the-age: WoA, worldly-wisdom: WoW, KNOGE Tree)**

In the garden.

Throughout History. (Any exaltation of man.)

James' and Paul's discourse'.

## **The Holy Spirit of Wisdom.**

Comfortable being uncomfortable with the Trinity.

Holy Spirit (Jesus other self) as Wisdom.

Wisdom – Primary among The Seven Spirits of God.

## **What do they say about The Spirit of Wisdom? (Chronologically)**

Moses:

Solomon:

Jesus:

Theologians:

It is because of God that you are in Christ Jesus,  
who has become for us Wisdom from God . . .

1 CorInthlans 1:30

# Start Me Up!

## General Introduction to Wisdom's House

Wisdom's House Publications

[www.wisdomhouse.org](http://www.wisdomhouse.org)

**Week 2:** During these two hours we will learn the role of Wisdom at creation, and that Wisdom's House is The Family of God (a Tree of Life.)

We will learn how I AM procured Wisdom to be the builder that laid the foundations of the earth, and to build His House which is His Family. We will learn that a "house" is not a building, but a blood-line. We will also learn that "obtaining children" is the LORD's method of building His House. We will see The LORD's House in the "Focus of Four" - Life, Family (bio & spiritual), Community (7 Mountains), and City.

**The LORD (I AM) "GETS" Wisdom. (The LORD's general contractor.)**

The Foundation of Revelation. ("Let there be light.")

Revelation = Perspective - The helicopter effect.

The Eyes of Heaven - Septnocular Vision.

**The LORD (I AM) sets the pattern for all of humanity - "GET" Wisdom!**

The Three Pronged Test. (Is it: Scriptural, Historical, Experiential.)

Personal revelation (Salvation.)

World-View revelation (Maturing in The Lord.)

The Intimacy Conspiracy (The Message of Wisdom for the Mature.)

Wisdom "in the beginning."

Wisdom "Layer of foundations."

Wisdom "builder of a house."

## Wisdom BUILDS her HOUSE.

|         |        |   |
|---------|--------|---|
| Builds: | bānāh  | A primitive root; to build (literally and figuratively): - (begin to) build, obtain children, make, repair, set (up), X surely. |
| House:  | bayith | Probably from H1129 abbreviated; a house (in the greatest variation of applications, especially family, etc.):                  |

Family Tree (Tree of Life) - Roots and shoots.

The seed from 1<sup>st</sup> Adam to 2<sup>nd</sup> Adam (both Son's of God.)

Pre-Israel (physical seed)

Israel (physical seed)

The Church (spiritual seed)

## Wisdom's Building Blocks (The Focus of Four.) - Outline for the next 4 weeks.

Your Life.

By far the most important house! If no success here, the others will never be built.

The more central the more cosmic.

Your Family.

Biological/Nuclear (1<sup>st</sup> Mountain)

God's Family (2<sup>nd</sup> Mountain)

Your Communities. (FRoGBEAM)

Family, Religion, Government, Business, Education, Arts & Entertainment, Media.

Your City.

The measuring increment of His Family, The Church.

And the child grew and became strong;  
he was filled with Wisdom,  
and the grace of God was upon him.

Luke 2:40

# Start Me Up!

## General Introduction to Wisdom's House

Wisdom's House Publications

[www.wisdomhouse.org](http://www.wisdomhouse.org)

**Week 3:** During these two hours we will learn how Wisdom built Jesus' life and how God's Secret-Mystery Wisdom was released at the cross, the door to Heaven's Kingdom.

We will learn some new language: "Got Food, Will, Work.", "Efficiency Rating" and others. We will learn why Jesus got 100% on the 'Heaven's to do list' test, and what role did the Spirit of Wisdom play in Jesus getting such a high efficiency rating?

**Jesus will ALWAYS be our example. (Got Food, Will, Work.)**

How did Wisdom impact Jesus from early in His life?

Heaven's Food = Bread/Revelation

Heaven's Will = Our Food

Heaven's Work = Finish the Fathers Work.

The Table prepared by Wisdom.

**Where you go I'll go, what you say I'll say = Efficient. (Efficiency Rating)**

The "to do list" of heaven - what are we on the hook for?

Written before you were born, found in The Secret Place.

What are we able to do and still not 'know' him. (SiWiHiA)

**The Cross: Hidden from the foundations of the earth – destined for OUR glory.**

Releasing the secret power of death.

100 different ways on 100 different days

Kernel of wheat.

Entrance point to the Kingdom.

The Lord's intent for the Church.

Intimacy Conspiracy: Christianity 101, 201, 301

I thought, 'Age should speak; advanced years should teach wisdom.' But it is the Spirit in a man, the breath of the Almighty, that gives him understanding. It is not only the old who are wise . . .

Job 32:7-9

# Start Me Up!

## General Introduction to Wisdom's House

Wisdom's House Publications

[www.wisdomshouse.org](http://www.wisdomshouse.org)

**Week 4:** During these two hours we will learn how Your Life is the first house to build through Wisdom's growth cycle: INTIMACY ~ REVELATION ~ INTERCESSION. We will see how the Spirit in Wisdom is available to the young. How Wisdom will build our lives if we GET Wisdom. How Wisdom feels about parents and kids by listening to what she says as she is calling out to them.

**Your Life: Wisdom's First House.**

Heaven's growth cycle: INTIMACY ~ REVELATION ~ INTERCESSION

The revelation of time. (The Spirit of the Fear of the Lord.)

**First Command: Love God = Violently Pursue Intimacy**

Intimacy -

Revelation

**Second Command: Love Your Neighbor as much as you have Revelation of His Love for you.**

Intercession - All prayer is intercession, but not all intercession is prayer.

Why productivity is the primary evidence of Wisdom's intimacy.

Obedience and the Decision Making Model.

How Jesus brought the Father glory.

How we bring the Father glory . . . our deeds and the releasing of LIGHT.

**What if we could start early? What if we could get this to the next generation early?**

Elihu

Jesus

Available to the young, but Satan's wisdom keeps it from them - TO LOCK UP HEAVEN'S KINGDOM!

**Turning the hearts of the children.**

Wisdom's call to the Fathers & Mothers.

Wisdom's call to the Sons & Daughters.

What will the children turn their heart TO in the great and terrible day of the Lord?

What families that are built by Wisdom will look like. (Next Week.)

By Wisdom a House is built . . .

Proverbs 24:3

# Start Me Up!

## General Introduction to Wisdom's House

Wisdom's House Publications

[www.wisdomhouse.org](http://www.wisdomhouse.org)

**Week 5:** During these two hours we will learn how Wisdom Builds Your Family and The LORD's Family. How we must activate Operation Generation Rescue.

Understanding the primary purpose of the nuclear family and how we are expected by God to pass Heaven's Kingdom from generation to generation. How to HOP in your house! How Wisdom's builds God's Family, The Church by the Spirit of Adoption. New Language: "Grandfather Clause." "Biological arrows" and "Spiritual arrows."

### The Nuclear Reactor Family:

Releasing light - heat - life in the home.

Offspring - biological and spiritual, roots and shoots

How to see you children as your number one spiritual offspring.

Wisdom's front door: the Fear of the LORD is the beginning of Wisdom.

How good can it get? Prophet, King, & Priest - Dad!

Discipline = Disciple-making (Loving Discipline)

Releasing The Blessing

The CHOP.

Work ethic - whoever has, more will be given.

## The Spiritual Family – The Church – Wisdom’s House:

The word ‘church’ – ecclesia: called out . . . for the purpose of council, governance.

Relationship – Sonship – Discipleship.

Individuals, Institutions, and Personalities

Individuals don’t interact well with institutions.

Thesis: “If an individual has an unhealthy dependence on an institution or a personality, both will fail.”

Spiritual socialism breeds agnostic Christians.

The wisdom of the age and humanities default mode.

Towers and Kings

v.

Many hands makes light work.

7 Mountains – practical, if not prophetic.

**Balance:** We will always have buildings, organizations, governments, and institutions. “They” are not evil – it is the mind-set and/or motive they are mixed with that can be VERY wasteful of time and resources.

Wisdom has built her House, she has hewn out  
it's seven pillars.

Proverbs 9:1

# Start Me Up!

## General Introduction to Wisdom's House

Wisdom's House Publications

[www.wisdomshouse.org](http://www.wisdomshouse.org)

**Week 6:** During these two hours we will learn how Wisdom Builds a Community. (FRoGBEAM)  
(Family, Religion, Government, Business, Education, Arts & Entertainment, Media)

Where does the Bible talk about Seven Mountains? Where did the current Seven Mountain message originate? Seeing our lives, cities, and nation through the Seven 'Societal' Mountain grid. Training in understanding how to release Heaven's Kingdom in the spheres of influence we dwell in every day, and where Wisdom Cries Out.

**Seven Nations greater than ours – Kings like hills.**

Seven Hills which are Seven Kings

Seven Mountains v. Towers and Kings.

**Bill Bright and Loren Cunningham have lunch.**

What in the world is a FRoGBEAM?

Family, Religion, Government, Business, Education, Arts & Entertainment, Media.

**How do we release Heaven's Kingdom in ALL spheres of life.**

All saints are in the ministry. (Don't let this freak you out – grace and peace.)

Sacrifice and service – secret Wisdom bombs.

The Spirit of Wisdom/Adoption in 7 mountains. (So much to develop here.)

Work ethic – whoever has more will be given.

Prayer v. Profit motive.

Faith at Workplace Phenomenon.

**LOCATION! LOCATION! LOCATION! – Wisdom’s choice of locations:**

Highest point in the city:

Gates:

Tops of the Walls:

Public Square:

Intersections:

Wisdom calls aloud in the street, she raises her  
voice in the public squares;  
at the head of the noisy streets she cries out,  
in the gateways of the city she makes her  
speech:

Proverbs 1:20-21

# Start Me Up!

## General Introduction to Wisdom's House

Wisdom's House Publications

[www.wisdomshouse.org](http://www.wisdomshouse.org)

**Week 7:** During these two hours we will learn how Wisdom Builds a City.

Seeing with Heaven's Eyes - a city as the measuring increment Heaven uses for The Church. What are the ancient walls, foundations, and boundary stones of a city? Learning what causes a city to become a 'Harlot city', and what causes it to be restored to 'Faithful City' status, and become a city on a hill.

**Wisdom, the releaser of perspective-revelation.**

The Eyes of Heaven

The Church measured in increments of a city.

Where Wisdom builds her house.

Ancient, Ancient, Ancient - out of eternity . . . UNSEEN.

**The Poor - not a peripheral issue.**

Will not judge or make decisions but with righteousness judge the poor, righteousness make decisions for the needy, 16 . . . in judging seeks justice, and speed the cause of righteousness

Righteousness & Justice - Foundation of Throne . . . Foundation for Intercession with weight.

Humble, Seeking, Outcast, Broken, Foreigner, Poor, Lowly, Faithful, Alien, Thirsty, Stranger, Wounded, Contrite, Crushed, Merciful, Fatherless, Abandoned, Knocking, Lame, Abused, Desolate, Asking, Willing, Accused, Deaf, Widow, Hurting, Broken-hearted, Meek, Eunuch, Barren, Persecuted, Pure, Despised, Blind, Peace-maker, Poor-in-spirit, Hungry, Pure-in-heart, Lover-of-God.

**God's Ancient Structures are moved based on how we handle the poor.**

Ancient Walls

Ancient Boundary Stones

Ancient Paths

**Wisdom Builds a City . . .**

By Crying Out Night and Day.

By going after the poor.

By going after the next generation.

By equipping The Church to release the Spirit of Wisdom (the secret power of death) in the Seven Mountains.

**Intercession that is ONLY Prayer generally pushes God's grumpy button.**

# The Focus of Four

Wisdom's House Publications

[www.wisdomhouse.org](http://www.wisdomhouse.org)

These are not to be considered the only four areas we will build in, but they will keep us busy for most the rest of our lives! These are the areas the Lord showed us when we asked Him how to simplify the message. We will regularly gather as a focused and willing group, committed to discover and understand how . . . **Jesus as Wisdom Builds:**

## Life

Wisdom builds a life by equipping individuals to have productive obedience out of Intimacy with Jesus by mentoring each one to know Jesus as the bread of life. It is vital that the people of God know how to get bread for themselves, in addition to receiving from others. Jesus accomplished everything His Father had for Him to do because He was filled with, and grew in, the Spirit of Wisdom as a child and young man (Luke 2:40 & 52). The Spirit of Wisdom enabled intimacy with His Father to establish the highest productivity a man has ever known. This is available to each of us, if we GET Wisdom.

## Family

Wisdom builds a Family by establishing the nuclear Family as the foundation of all government, and the best way to release the Kingdom from generation to generation. We will do this by creating an environment of training in the religion mountain that sets an example for parents how to build their family in Wisdom. Specifically utilizing the Hebrew perspective of Wisdom uncovered in the picture of a nail being pounded into a wood until it is buried. Wisdom's Tool Box is full of 'nails' to get into the next generation by setting a culture in the Wisdom's House community. Here we train families and the family of God through "cultural memorization" – having common sayings and phrases that dads, moms, and kids can build on - concerning the Holy Scriptures, the seven societal mountains, families, the Kingdom of Heaven, and the Church. This is where we will launch an Anointed Generation

## Communities (Bill Bright/Loren Cunningham testimony: Seven Mountain Message @ wisdomshous.org)

Wisdom builds communities 7 Pillars or Seven Mountains of Society by releasing the Kingdom first in the family, then in God's family (the Church) then in Government, Business, Education, Arts & Entertainment, Media realms. We will develop a world view that all saints are to be equipped to release the Kingdom of Heaven in their sphere of influence. This is where Wisdom Cries Out, and also where she competes with The Woman Folly for the hearts and minds of mankind. Training the People of God to release the Kingdom of Heaven in their daily spheres of influence through service and sacrifice will cause the secret power of His Kingdom to, like leaven, begin to change the culture. This will also help ALL of the People of God to see that we are not all called to traditional vocational ministry (religion mountain), and that each of the societal mountains is holy to the Lord. Wisdom has hewn out the Seven Pillars of her house.

## City

Wisdom builds a city by rebuilding the ancient walls and ancient foundations of a city (Isaiah 58) and transforming cities into Faithful Cities (Isaiah 1) by focusing specifically on the position of the single-mother and fatherless children. Within the "Jesus as Wisdom World-View" the written word reveals what modern day statistics confirm; poverty is sustained in a city when the People of God DO NOT plead the case of the "widow" and defend the cause of the fatherless. If we are not actively doing this, then we are in the camp of the oppressor. We will equip **City Building Teams** to strategically "**Carecoach**" a single mom and her kids, while also building Wisdom's House of Prayer in a city.

# Three 'New' Cultures of Development

Wisdom's House Publications

[www.wisdomhouse.org](http://www.wisdomhouse.org)

Because the Eyes of Heaven cause us to see things differently, it is vital to first overcome cultural and language barriers (yes, even in the U.S.) to help others see things differently. This is vital to building in step with Wisdom and exposing Satan's wisdom. This is no small task. Therefore, we will start by focusing on establishing *three cultural dynamics*:

## New Language Culture

Capturing new ideas (that are really old ideas) with easy to remember wording that helps communicate Wisdom's perspective. Examples of New Language: "Got Food, Will, Work.", "Missions-Trip Lifestyle", "The Seven Mountains of Society", "Wisdom's House - The Family of God", "Secret Power of Death (SPoD)" "Faithful Cities", "Efficiency Rating", "We Are the Church", "Observational Intimacy", "All prayer is intercession, not all intercession is prayer", "Spatial Relationships", "Redeeming time & space", "Journey of Intimacy", "Carecoaching", "City Building Team", etc.

## Simple Action Culture

Getting to work while we are getting Wisdom. Making the next generation, the seven mountains, the poor, Israel, and the house of prayer our priorities. In the end, we will say of the message of Wisdom that it caused us to become experts at common sense. A life of Intimacy with Jesus flows out of simple and pure devotion to Him. There are some simple disciplines and actions that result in intentional and strategic use of time with ALL children, young and old, biological and spiritual, and with single-mothers and their children (the widow and orphan of our day), because Wisdom is known by her 'children'. (Luke 7:35) By moving it away from institutional structures into groups of individuals who have natural community, we can surround these who are high on the Lord's priority list. Equipping the saints to do the 'work of the ministry' so that the Body might come into unity (Ephesians 4:11-12). Because Wisdom is also known by her 'works'. (Matt 11:19). **We will equip all to release the Kingdom of Heaven in every sphere of life (7 mountains), including their local congregations.**

## Jesus as Wisdom World-View Culture

Discovering why the LORD chose Wisdom to lay the earth's foundations, build His Family, and undo Satan's wisdom-of-the-age. These are all long-term goals of Wisdom's House. All that we do will begin to be founded on the understanding the The Great I AM had a purpose in procuring Wisdom to be His general contractor as He founded the earth (Proverbs 8:22-31, 3:19, 9:1, & 24:3, Psalm 104:24, Jeremiah 10:12). Wisdom is His special secret that is critical to building a Life, a Family, His Family, Communities (Seven Mountains), and a City - because He revealed it in His Son on the cross (1 Corinthians 2:6-10) and now wants us (the Church) to reveal this Secret Power of Death (SPoD) to the principalities and powers (Ephesians 3:10). Wisdom will also play a critical role in the time when He uncovers The Harlot and the Beast that she rides (Revelation 17:9), and also the man of lawlessness (Revelation 13:18) and how the Church can walk in Wisdom, redeeming our times.

# Some of Wisdom's House "New" Language:

In All Things Violently Pursue Intimacy  
With The Living Christ.  
(Love God.)

"How can I help you build your life in Jesus?"  
(Love your neighbor.)

All prayer is intercession,  
but not all intercession is prayer.

Enter Eternity.

Those who do today what others won't,  
Will do tomorrow what others can't.

Paradox.

You are what you eat.  
So what's your M.E.A.T?  
(Where do you spend your Money, Energy, Affection, Time?)

He who makes provision for the present - but none for eternity, is wise  
for a moment - but a fool forever.

Already done, still needs to happen.